

 NEWSKILL

SCYLLA

QUICK GUIDE

WIRELESS GAMING HEADSET



NEWSKILL SCYLLA WIRELESS GAMING HEADSET

DIAGRAM



Package Contents

SCYLLA / 2.4G Wireless gaming headset
Audio adapter cable
Micro charging cable
Detachable microphone

Function of Volume Control

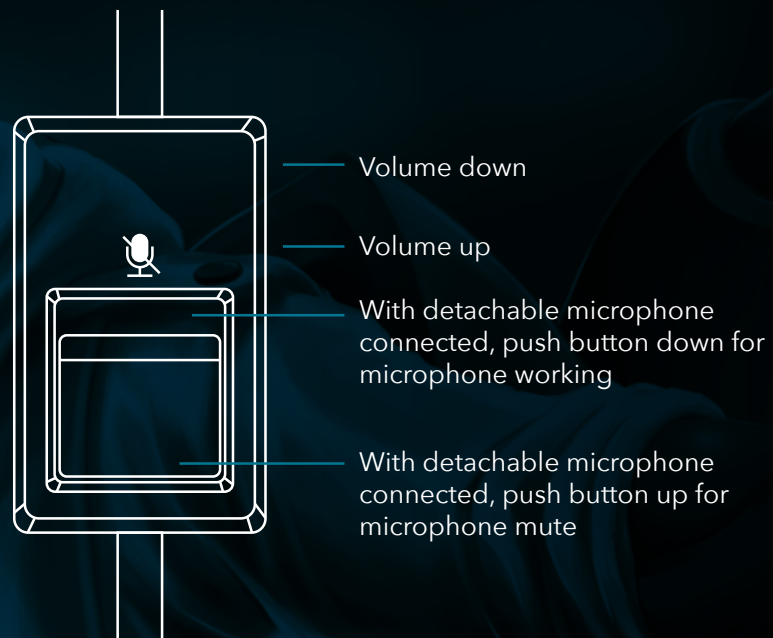

Operating instructions

A. Fill the battery before first usage

B. Have the distance between headset and dongle within 20 cm when pairing

C. Have the distance between headset and dongle within 10 m when using, and the valid distance would be shortened if there are obstacles

D. Power on / off

Power on: have the switch at the position of "on", and indicator blue light is on and flashes.

Power off: have the switch at the position of "on", and indicator blue light is off

E. Connection

Connection between headphone and dongle by wireless:

(1) First connection: have the dongle connected with USB plug of PC/PS4, and press the "EQ" button on headphone for 4 seconds with indicator blue light on headphone flashing and the beep sound until it is connected.

(Indicator red light on dongle would be on when connected to PC/PS4 successfully, and keeps flashing before connected to headphone)

(2) Reconnection: if the connection between dongle and headphone was made before, the reconnection would work automatically in 2 seconds when the headphone & PC/PS4 is power on

Connection between headphone and platform by audio cables:

Have audio cable for connecting PC/PS4/SWITCH/XBOX ONE/SMARTPHONE (Xbox One Stereo Adapter may be required, purchased separately)

Attention : 2.4G wireless connection must be off when using audio cable

Operating instructions

F: Microphone usage

With detachable microphone connected to the headphone

- (1) Press the mute button, microphone is mute if with that indicator red light of microphone is visible
- (2) Press the mute button, microphone is working if with that indicator red light of microphone is not visible

With detachable microphone unconnected to the headphone, microphone is not working.

G: Sound mode usage

3 sound mode of "Standard", "Bass", "3D", and could be changed by clicking the "EQ" button one time with "beep" to remind user about the successful change.

(Remark: the sound mode would be the same if the power is re-started)

Attention points

Charging time: approx. 3 hours to fill the battery

Charging indicator: When charged, the red light on the product will be on; and it will be off when the battery is filled,.

Low power indication: When the battery power is low, "beep" would come each 30 seconds, and please charge the battery immediately.

In order to maintain the battery life, the product will automatically shut down, when the product battery power is too low

Auto-power: Headphone would be under the state of dormancy when there is no music or matching in 10 minutes, and would be automatic power off in 15 minutes, even though the switch is at the position of "on"

(Reminder: Has to make the switch from the position of "off" to "on" if you want to re-start the headphone)

Indication of the blue light on headphone:

- (1) The product is in the connecting state: the blue light is always on.
- (2) The product is in an unconnected state: the blue light flashes slowly.
- (3) When the product is searching for matched equipment, the blue light flashes.

Instruction on lighting control

Constant light mode

Seven lighting colors of green - red - Purple - yellow - Blue - Pink - white could be cyclic switching by clicking the button one time.

Breathing light mode

Under constant light mode, it could be changed into breathing light mode by double-clicking the button, and the color of the light is still the same.

Seven lighting colors of green - red - Purple - yellow - Blue - Pink - white could be cyclic switching by clicking the button one time. However, the light mode would be constant light mode again if changing the lighting color

Respiratory Mode of Colorful light

Under breathing light mode, it could be changed into colorful light mode by double-clicking the button, and the color of the light is cyclic switching as mentioned above, changed from green - red - purple - yellow - blue - pink - white.

Switch light mode

Under respiratory Mode of Colorful light, it could be changed into constant light mode by double-clicking the button.

Turn off the light by long press

(Remark: the lighting mode would be the same if the power is re-started)